

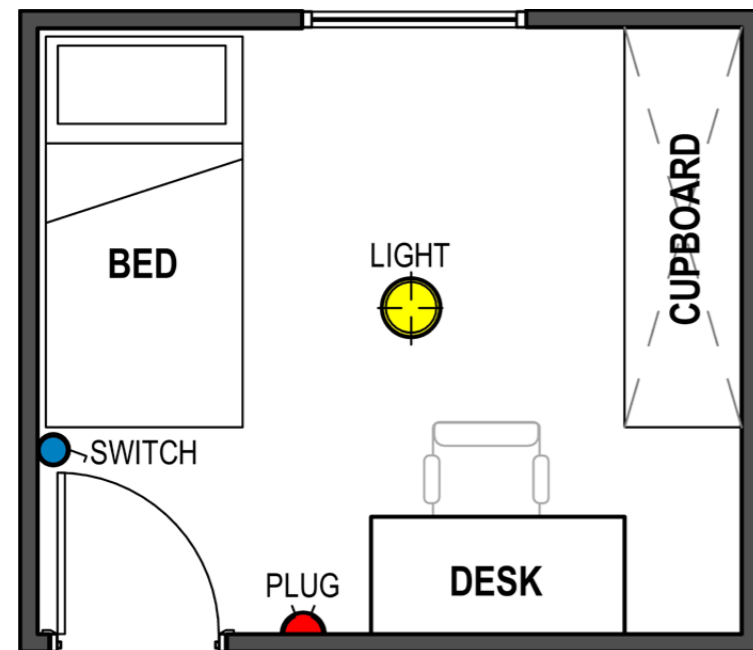

COMPACT MODULAR

CONVENTIONAL ROOM



Room Area = 11m²

COMPONENTS MOVED TO MODULE

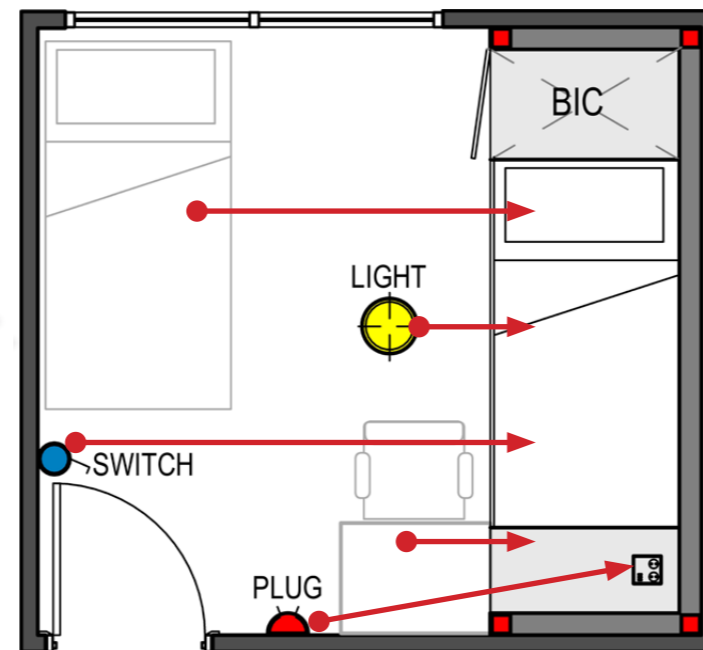

COMPACT MODULE

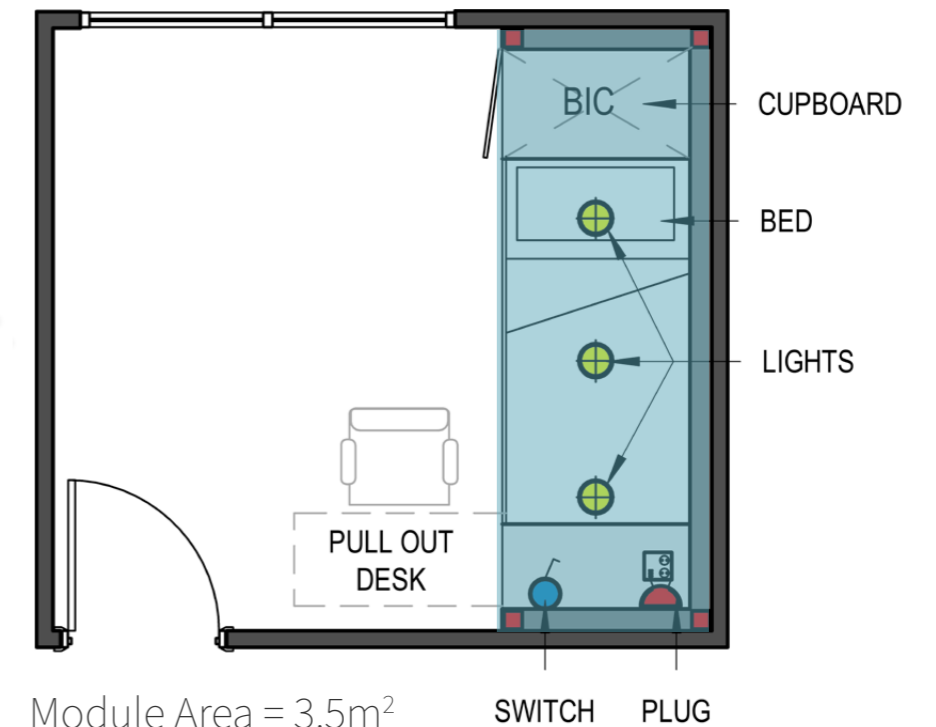

Module Area = 3.5m²



WHAT IS COMPACT MODULAR?

- Compacts large areas of a room into a single unit
- All services & accompanying elements are compressed into a single, smaller space
- Focusses on pre-engineered, off-the-shelf modules
- No “empty spaces” are transported from the factory to the site
- Environmentally friendly design & construction methods
- Combines the efficiency, flexibility & mobility of different types of construction
- Library of modules allows total flexibility when designing & building
- Costs and site activity are reduced by skilled work being completed in a factory
- Each module is designed to fit into any high-cube shipping container so that they can be shipped anywhere worldwide